



Product Care Association

We need a better system title for here

# Ontario Service Provider Portal

Lots of boilerplate text goes here.....

Bacon ipsum dolor amet shankle pork belly beef ribs capicola ground round prosciutto. Bacon capicola kielbasa, chuck pork belly ham ribeye tail meatloaf sirloin ham hock. Flank venison corned beef brisket andouille frankfurter hamburger pork chop short loin cow meatball beef ribs. Turducken meatloaf ham tail pork, cow boudin beef ribs. Chuck kevin cow biltong, leberkas tail bacon drumstick kielbasa shankle alcatra swine chicken landjaeger. Kevin leberkas ground round, biltong picanha brisket venison beef tail ham pig porchetta.

Your Email

Password

Log In

Turducken meatloaf ham tail pork, cow boudin beef ribs. Chuck kevin cow biltong, leberkas tail bacon drumstick kielbasa shankle alcatra swine chicken landjaeger. Kevin leberkas ground round, biltong picanha brisket venison beef tail ham pig porchetta.

[Become a Service Provider](#)

If user with email exists,  
this text appears just  
below the hyper-link:

[I forgot my password](#)

An email has been sent with instructions  
on how to reset your password.

A user with your email address could  
not be found.

If user with email does not exist:

Become a member links to this  
address:  
[http://www.regeneration.ca/  
programs/paint/ontario](http://www.regeneration.ca/programs/paint/ontario)

This is a sample email they would receive if they click "I forgot my email"

webmaster@productcare.org



To: Annie Forgetful

**Password Reset**

Dear Annie,

This is an automated message sent from productcare.org.

Click the link below to reset your password:

[productcare.org/login\\_reset?pw=Q@S2S#d\\$%fG](http://productcare.org/login_reset?pw=Q@S2S#d$%fG)

This link will only work for one hour.

Thank you,

Product Care Association

TOLL-FREE: 1.877.592.2972

Please do not reply to this email.

If you continue to have problems, please call the toll-free phone number listed above.



Product Care Association  
Ontario Service Provider Portal  
**Reset Password**

Welcome Annie Forgetful, please reset your password

New Password

Repeat New Password

Reset Password

If pw's don't match, show this: Your passwords do not match. Please enter matching passwords

Otherwise, go to the user role landing screen  
for the logged in user, the same as if they had  
successfully logged in.

Nothing is editable on  
this page, it is view only.



Product Care Association

## Ontario Service Provider Portal

Jim McNeely  
Big Truck Transporters

Account

Submissions

History

Contact

## Company Information

Company Name: Big Truck Transporters

Main Phone: Big Truck Transporter

Street Address 1: Big Truck Transporters

Other Phone: Big Truck Transporter

Street Address 2: Big Truck Transporters

Fax: Big Truck Transporter

Street Address 3: Big Truck Transporters

City: Big Truck Transpc Province: Big Tru

Country: Big Truck T Postal: Big Truck

## Locations

Name

Manning Drive HHW Depot

Manyard HHW Depot

Markham HHW Depot

Middleville HHW Depot

Millenium Material Transfer Site

Mississippi HHW Depot

Mitchell HHW Depot

## Registered Portal Users

Name	Email	Role	Active
Jim McNeely	jmcneely@bluscs.com	Administrator	<input checked="" type="checkbox"/>
Jane Doe	jdoe@gmail.com	data entry, history	<input checked="" type="checkbox"/>
John Doe	jwdoe@hotmail.com	data entry	<input checked="" type="checkbox"/>

In phase 2:

- add or edit users
- site - click causes popup of site details
- form to apply for a new site (would need approval)



# Product Care Association Ontario Service Provider Portal

Jim McNeely  
Big Truck Transporters

Account Submissions History Contact

Submission Title:

Ontario Recycles 2015

Shipping Documents

File Name	Edit
17342-9.png	
17343-1.pdf	
17347-3.doc	

Save  
without  
submitting

Saved Unfinished Submissions

No.	Title	Date	Entered By	Delete
24356	January Depots	2/7/2015	j. McNeely	

Download Template

Upload Spreadsheet

	Program	Service Type	Ship Doc No.	Pickup Date	Delivery Date	Site ID	Collection Site	Transporter	Processor	Material Category	Container	Unit	Qty	Weight	Comments	Delete
	Paint	Transportation														
	Paint	Transportation														
	Paint	Transportation														
	Paint	Transportation														

Submit Claims

- Saved Unfinished. Clicking on a row loads that data into the portal. If there is already data, it asks if you want to save first. If not, it discards it all. If so, it runs through the save sequence and checks to make sure the form validates for saving without submitting.
- This navigation button and page (Submissions) are only visible to users with a role of "Administrator" or "Data Entry" assigned
- Upload Spreadsheet button causes ss\_upload box to appear. Once file is chosen and submitted, all rows are uploaded whether they validate or not, and invalid values are noted with red-hilited cells.
- Plus sign causes "bol\_upload" box to appear. Once uploaded, the new BOL is auto=-selected. Clicking on a row selects one. Control clicking selects multiple.
- Clicking a BOL cell in the claims rows auto-enters the selected doc number(s). Multiple docs are separated by a space.
- Plus sign to the upper right of the claim lines creates a new claim line at the bottom of the others, which is editable in line. In line edits follow the rules noted in the table above..
- Submit Claims button is disabled if there are any critical validation errors, which are indicated as hilited in red; cells validate on blur. Non-critical validation errors are hilited in yellow, and do not disable the submit button.
- Once submitted, a floating box appears saying that the claim was submitted, and if it was a spreadsheet that was edited, it displays a disclaimer that the submitted version is the official version. Then the claims table blanks out, the shipping documents table blanks out, and all fields go back to defaults, and it is ready for a new submission to be created.
- Save without submitting requires a Submission Title. Upon clicking this without one, it displays "Please enter a Submission Title" in red letters just below the field, and gives that field the focus.

Duplicate line button - creates a duplicate of the selected claim line just below, and puts the focus in the first blank field of the new line

This is part of the submissions page. It is a hidden div which floats over the other layouts if the "Upload Spreadsheet" button is clicked.

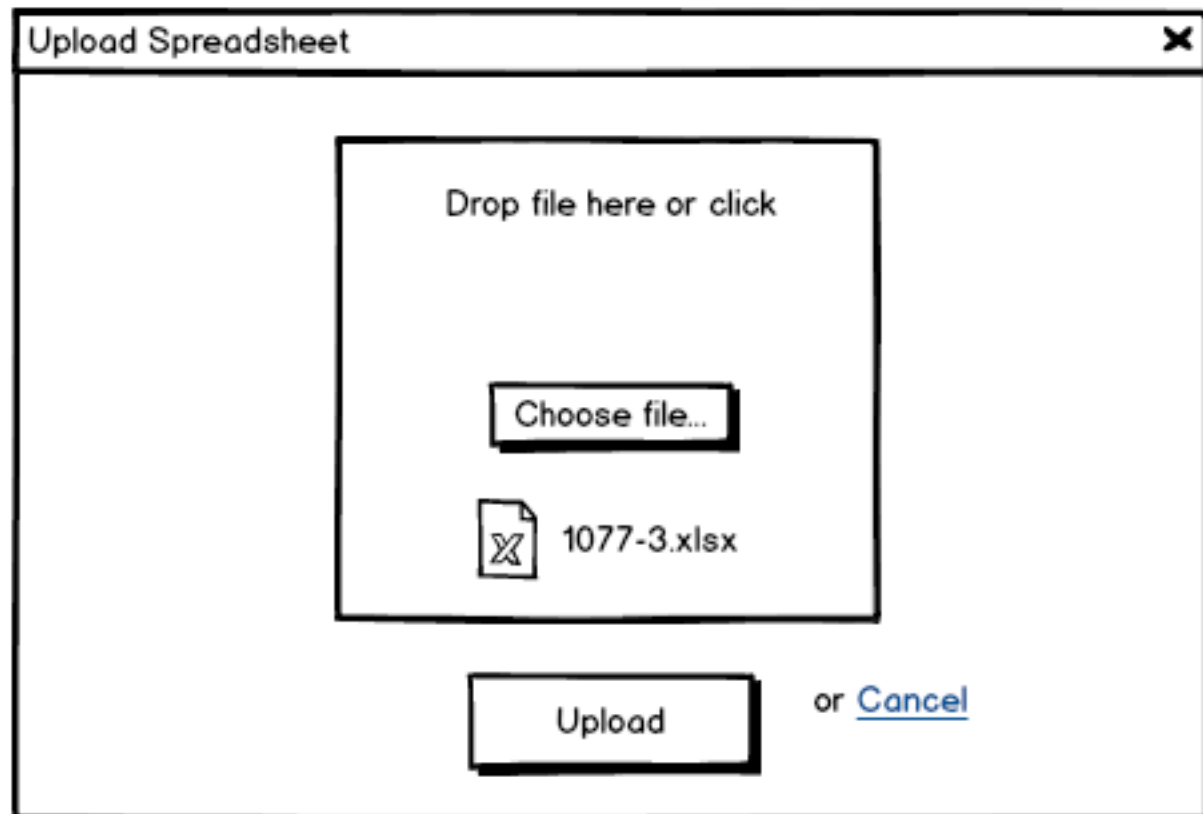

put text on here that says you have to use a template, not just any spreadsheet

Upload validates that it is a xls or xlsx document, and a valid template file

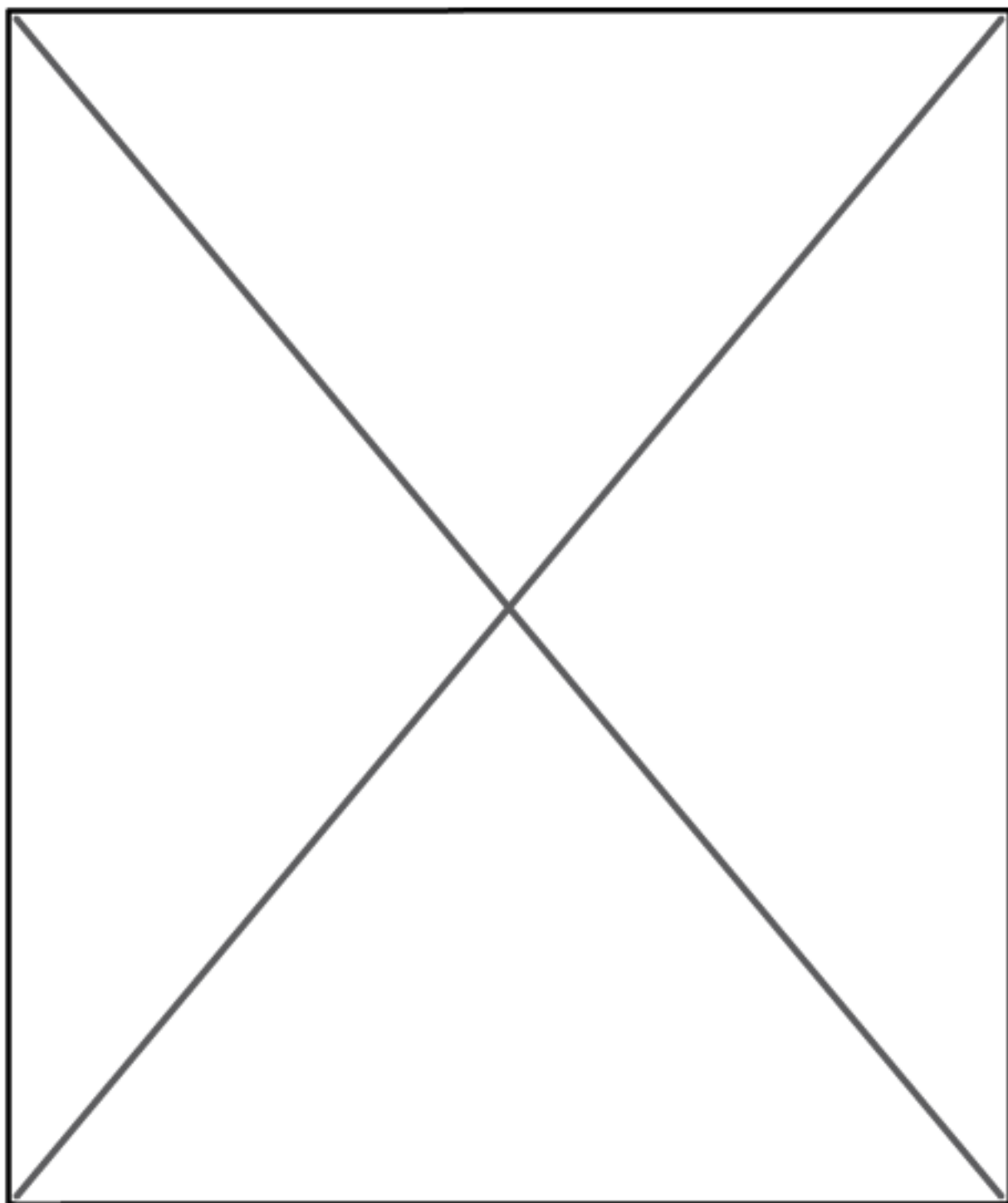

File Name: 234365.jpg



or [Cancel](#)



This is part of the submissions page. It is a hidden div which floats over the other layouts if the "New Doc" plus sign is clicked, or the "Edit" button is clicked for a row.

Add/Edit Supporting Documents✕

Drop file(s) here  
Or click  
Choose file(s)...

 1077-3.pdf 

 1077-4.pdf 

 1077-5.pdf 

Save

 or [Cancel](#)

Document number auto-enters from uploaded file name if empty, but is editable. Document number is required, file upload is not required

If this is an existing Doc Number that is being edited, if a file is uploaded it overrides and replaces the old file.

Delete first confirms that the user wants to delete and tells them it is not reversible. If confirmed, it deletes this doc number, file, and removes it from the list.

This is part of the submissions page. It is a hidden div which floats over the other layouts when a submission is successfully committed.

Submission Sent Successfully!



The Submission was successfully sent to PCA.

Since you made changes within the portal to the submission prior to sending, the spreadsheet that you originally uploaded is now different than your submitted version. The submitted version is the official version. You will receive a confirmation copy of the submission shortly in your email, or it will be available for download from the portal in the history section.

OK



## Advanced Search

Title	Number	Date	Status	Amount
Recycle On...	20071	4/7/2015	Approved	\$3,217.23
Ontario De	20033	3/9/2015	Paid	\$1,723.17
<div> <div>Ontario Depot</div> <div>Pickups March 1-7</div> </div>				

Amount

**\$1723.17**

File Name	View
17342-9	
17343-1	
17347-2	

Print Submission

Save Submission as PDF

Export Submission as Excel

[illegible]

This is part of the submissions page. It is a hidden div which floats over the other layouts if the "Upload Spreadsheet" button is clicked.

Advanced Search

Submission Title

Submission Number

Pickup Date

1/1/2015

To

6/1/2015

Delivery Date

1/1/2015

To

6/1/2015

Status

Review

Collection Site Name

Service Type

Transportation

Site Type

Event

Document No.

Material Category

Paints & Coatings

Search

or [Cancel](#)

Initial values:  
text inputs are blank  
date fields are blank  
drop-downs are "All"

#### Service Type

All

-  
Transportation  
Processing  
Post-Collection Services  
Event Collection

#### Site Type

All

-  
Event  
Depot  
Retailer

#### Material Category

All

-  
Paints & Coatings  
Aerosols - 331  
Paint Exchange

#### Status

All

-  
Review  
Approved  
Paid  
Rejected

<b>Claim Summary</b>
<b>Submission ID:</b> 73527
<b>Submission Date:</b> 2/17/2015
<b>Status:</b> Approved
<b>Amount:</b> \$1723.17
<b>Terms of Payment:</b> 30 days

[illegible]

This is a print form that can either be printed or saved to a PDF



Product Care Association

## Ontario Service Provider Portal

Jim McNeely  
Big Truck Transporters[Account](#)[Submissions](#)[History](#)[Contact](#)

For General Inquiries

Head Office

105 West 3rd Avenue  
Vancouver BC V5Y1E6  
CanadaPhone: 604-592-2972  
Toll Free: 1.877.592.2972  
Fax: 604-592-2982  
Email: [contact@productcare.org](mailto:contact@productcare.org)

For Accounting Inquiries

Phone: 604-592-2972  
Email: [contact@productcare.org](mailto:contact@productcare.org)

For Submission Inquiries

Phone: 604-592-2972  
Email: [contact@productcare.org](mailto:contact@productcare.org)

# Service Provider Web Portal Wireframes

Product Care Association – Portal Design Project

Prepared by Jim McNeely

Friday, March 6, 2015

This Wireframe Design Document accurately describes the system which  
Product Care Association is asking Blu Sky to build.

---

Mannie Cheung

---

Date

---

Vance Hackett

---

Date

---

Sarah Willie

---

Date